

SIGNIFY

BLUETOOTH® SPEAKER





Model Number: EA1344

INSTRUCTION MANUAL



AFTER SALES SUPPORT

  1300 777 137

Welcome

Congratulations on choosing to buy a Signify product.

All products brought to you by Signify are manufactured to the highest standards of performance and safety, and, as part of our philosophy of customer service and satisfaction, are backed by our comprehensive 1 Year Warranty and customer technical support line.

This comprehensive instruction manual will provide you with a detailed guide on how to operate your product and will also assist you in troubleshooting any problems that you may encounter.

If you have any queries regarding the use of this product, please feel free to phone our technical support line for some friendly advice. If you are experiencing difficulties or believe that the product may have a technical fault, we will assist you in rectifying the issue. We can generally solve most problems simply and quickly over the phone, so please always phone us first!

We are sure that you will enjoy using this product and you can expect to gain years of service from this product when it is used and maintained in the correct manner.

Contents

Welcome	02
Warranty Details	04
General Information and Safety Instructions	05
Product Overview	07
Before First Use	08
Instructions	09
Other Useful Information	14
Cleaning and Maintenance	14
Storage	14
Responsible Disposal	15
Trademarks	15
Specification Table	15



SIGNIFY

Bluetooth® Speaker

Warranty Details

REGISTER YOUR PURCHASE AT www.aldi.com.au/en/about-aldi/product-registration/ TO KEEP UP-TO-DATE WITH IMPORTANT PRODUCT INFORMATION

The product is guaranteed to be free from defects in workmanship and parts for a period of 12 months from the date of purchase. Defects that occur within this warranty period, under normal use and care, will be repaired, replaced or refunded at our discretion. The benefits conferred by this warranty are in addition to all rights and remedies in respect of the product that the consumer has under the Competition and Consumer Act 2010 and similar state and territory laws.

Our goods come with guarantees that cannot be excluded under the Australian Consumer Law. You are entitled to a replacement or refund for a major failure and for compensation for any other reasonably foreseeable loss or damage. You are also entitled to have the goods repaired or replaced if the goods fail to be of acceptable quality and the failure does not amount to a major failure.

AFTER SALES SUPPORT

  1300 777 137

 service@unclebills.com.au

MODEL: EA1344 PRODUCT CODE: 63108 11/2018



General Information and Safety Instructions

RETAIN FOR FUTURE USE

Read this manual thoroughly before first use, even if you are familiar with this type of product. The safety precautions enclosed herein reduce the risk of fire; electric shock and injury when correctly adhere to. Please keep this user manual in a safe place along with your purchase receipt, warranty card and carton for future reference. If applicable, pass these instructions and packaging on to the next owner of the product. Always follow basic safety precautions and accident prevention measure when using an electrical product.

1. Read all instructions before using the Speaker.
2. The Speaker is not intended for use by persons with reduced physical, sensory or mental capabilities, or lack of experience and knowledge, unless they have been given supervision or instruction concerning use of the product by a person responsible for their safety.
3. Do not use the Speaker for anything other than its intended use.
4. Do not pull or carry the Speaker by the USB charging cable or the AUX cable.
5. Do not use the cables as a handle, close a door on the cables, or pull the cables around sharp edges or corners.
6. Do not leave the product unattended when connected to the power supply. To unplug, grip the plug and pull from the power outlet. Never pull by the cord.
7. Do not expose the Speaker to water, rain moisture, liquids or dust. Do not store or use the Speaker anywhere near water, or where water drips and may come in contact with this product.
8. Do not operate the Speaker with wet hands.
9. Unplug the Speaker in cases of electrical storms to protect against the possibility of power surges damaging the device.
10. Do not immerse the Speaker in water or any other liquids.
11. Repairs to any electrical equipment should only be performed by qualified personnel. Improper repairs may place the user at serious risk and will void the warranty.
12. Do not leave the Speaker unattended while connected to a media device.
13. Do not use the Speaker if it has been dropped or damaged in any way.
14. The Speaker is intended for household use only and should not be used for commercial purposes.
15. Store the Speaker on an even surface, free of vibrations and away from sources of heat.
16. This product is not a toy. Keep the Speaker out of reach of children.
17. Do not play music at excessive levels especially near children, as damage to hearing may occur.
18. The Speaker can be affected by magnetic interference created by items, such as computers, TVs, or electric cables. Avoid using the Speaker in areas affected by magnetic interference.

General Information and Safety Instructions (cont.)

19. Keep free of dust, lint, hair etc.
20. Check the USB charging cable and the AUX cable regularly for visible damage. If it is damaged, please contact the After Sales Support Line for further advice.
21. When the Speaker is not in use, switch it off.
22. This product is not user-serviceable. Contact with high voltage components may cause a risk of electric shock, therefore do not attempt to open the cover of the Speaker.
23. Install and operate the Speaker in a cool and sufficiently ventilated room to ensure it does not overheat.
24. The manufacturer and retailer are not responsible for any eventual damages caused by improper or faulty use.
25. Never operate the Speaker with wet hands, submerge under water or spill liquids into or onto the device.
26. Do not place the Speaker near a hot burner (gas or electric), other heat emitting sources or open flames.
27. To avoid damage and injury to persons, be careful when transporting the Speaker to ensure the unit does not fall.
28. If the Speaker has been exposed to strong fluctuations in temperature, do not switch it on immediately. Do not switch on the equipment until it has reached room temperature.

CAUTION: Danger of explosion if battery is incorrectly replaced. Replace only with the same or equivalent type.

WARNING: Batteries (battery pack or batteries installed) shall not be exposed to excessive heat such as sunshine, fire or the like.

Product Overview

TOP

BOTTOM

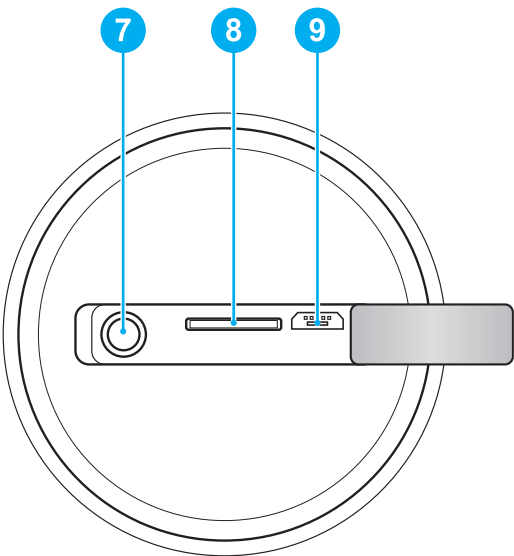
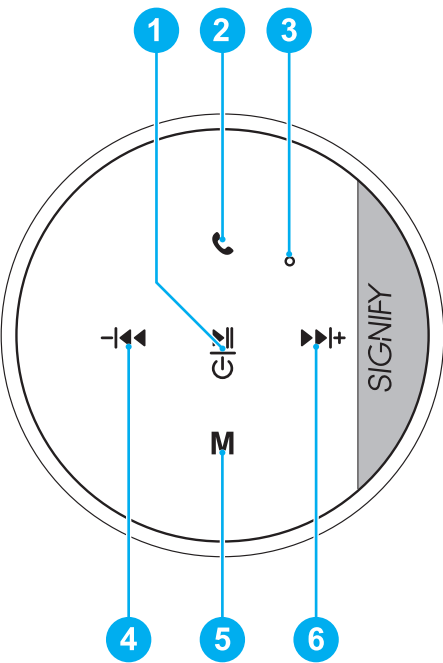

- 1. Button
- 2. Button
- 3. Microphone
- 4. Button
- 5. **M** Button

- 6. Button
- 7. AUX Input
- 8. Micro SD Card Slot
- 9. Charging Port

Included (not pictured):
AUX Cable and USB Charging Cable

Before First Use

Prior to using your Speaker, please read all safety and operating instructions thoroughly. Please ensure you follow the steps below before using this product. We recommend you keep the original packaging for storing your Speaker when not in use.

1. Unpack the product but keep all packaging material until you have made sure the Speaker is undamaged and in good working order. Plastic wrapping can be a suffocation hazard for babies and young children so ensure all packaging materials are out of their reach.
2. Make sure you have all parts listed in the Parts Overview.
3. Remove the twist-tie which is securing the AUX cable and USB charging cable. Uncoil the cables and straighten it to remove any kinks. Do not use the product if the cables or Speaker is damaged, please call the After Sales Support Line for further advice.
4. Place the Speaker on an even surface, free of vibrations and away from sources of heat.

NOTE: For more efficient usage, we recommend you fully charge the Speaker before use (see the "Charging the Speaker" section on page 09 for further information).



Instructions

Charging the Speaker

1. Connect the micro USB end of the USB charging cable (provided) into the charging port on the Speaker.
2. Insert the other end of the USB charging cable into a suitable USB port on your computer or similar power supply.
3. It takes approximately 4 to 5 hours to fully charge the battery.

NOTE: Overcharging the Speaker can adversely impact the battery life.

Turning the Speaker On/Off

1. To turn the Speaker on, press and hold the  button for approximately 3 seconds. The Speaker will sound a "Power On" message, indicating the Speaker is turned on.
2. To turn the Speaker off, press and hold the  button for approximately 3 seconds. The Speaker will sound a "Power Off" message, indicating the Speaker is turned off.

AUX Mode

1. Turn the Speaker on.
2. Plug the AUX cable (included) into the AUX port on the Speaker.
3. Plug the other end of the AUX cable into the desired media device such as smart phone, tablet, computer or other AUX compatible device. The Speaker will automatically enter AUX mode.
4. Play music/media from the media device.

NOTE: Please unplug the AUX cable from the Speaker or Bluetooth® mode cannot be accessed automatically. To access Bluetooth® mode manually while the AUX cable is still plugged in, please press the **M** button twice.

NOTE: See the "Playback Controls" section on page 12 for further information on playback controls within AUX mode.

Micro SD Card Mode

The Speaker features a micro SD card slot which enables MP3 files to be loaded onto a micro SD card and played back through the Speaker.

NOTE: Only audio files in MP3 format can be played successfully on your Speaker. Please ensure your audio files loaded on your micro SD card are converted to MP3 format before playing on the Speaker.

Instructions (cont.)

1. In order to play MP3 files on the Speaker, you will firstly need to load them onto a micro SD card.
2. Turn the Speaker on.
3. Insert the micro SD card into the micro SD card slot. Any loaded music on the micro SD card will automatically begin to play.

NOTE: Once the micro SD card is inserted into the Speaker, any music or other media being played through the unit will be stopped.

NOTE: See the “Playback Controls” section on page 12 for further information on playback controls within micro SD card mode.

FM Radio Mode

1. Turn the Speaker on.
2. Short press the **M** button once to enter FM Radio mode.
3. Short press the  button once to perform an auto-scan for all available stations in your area.

NOTE: You may need to relocate the Speaker in order to gain better reception.

NOTE: See the “Playback Controls” section on page 12 for further information on playback controls within FM Radio mode.

NOTE: You can plug the USB cable into the micro USD port input to act as an aerial; to further enhance the radio reception. If this is required, please plug in the cable before starting the FM Radio auto-scan.

Bluetooth® Mode

The Speaker features a Bluetooth® receiver which allows it to be connected to compatible Bluetooth® devices within a 10m radius. This allows the user to play and control tracks directly from their Bluetooth® device.

1. When connecting the Speaker to a personal device using Bluetooth® wireless technology, firstly turn the Speaker off.
2. Turn the Speaker on. The Speaker will automatically enter Bluetooth® mode, and will begin to search for nearby Bluetooth® devices.

NOTE: If the last connected device is within the Bluetooth® reception range of the Speaker, you will not be able to pair a new device to the Speaker. You will need to turn off the Bluetooth® connection on the last connected device in order to connect a new device.

Installation (cont.)

NOTE: If a micro SD card or AUX cable has been inserted into the Speaker, it will not automatically enter Bluetooth® mode, instead, it will enter micro SD card mode or AUX mode respectively. If this happens, simply press the **M** button twice to manually enter Bluetooth® mode.

- 3. On the Bluetooth® enabled device, activate (or turn ON) the Bluetooth® wireless connection, and search for nearby devices. When the device discovers “SIGNIFY SPEAKER”, select and connect to “SIGNIFY SPEAKER”. This will take a few seconds.
- 4. Once paired successfully, the Speaker will sound a "Device Connected" message.
- 5. You are now ready to play music/media from the Bluetooth® enabled media device.

NOTE: If the Speaker disconnects from the device, it will sound a "Disconnected" message. The Speaker will then work on automatically pairing back to the last connected device. When this occurs, the Speaker will sound a "Connected" voice message.

Managing Phone Calls

Operation	Function	Action	Button
Incoming Call	Answer Call	Short Press	📞 or 
Incoming Call	Reject Call	Long Press	📞
During a Call	End Call	Short Press	📞
Standby Mode and Connected to a Device	Redial Last Number	Short Press Twice	📞

NOTE: The Speaker must be connected to a device via Bluetooth® for the above functions to work (see the "Bluetooth® Mode" section on page 10 for further information).

NOTE: Not all mobile phones support all the functions listed above. Please refer to your mobile phone's user manual for further information.

NOTE: Certain functions and indication tones may vary depending on your mobile phone.

Installation (cont.)

Playback Controls

Function	Action	Button	AUX	FM Radio	Micro SD Card	Bluetooth®
Decrease Volume	Hold	⏮	✓	✓	✓	✓
Increase Volume	Hold	⏭	✓	✓	✓	✓
Pause Music	Short Press	⏸ ⏻			✓	✓
Play Music	Short Press	⏸ ⏻			✓	✓
Previous Track/Station	Short Press	⏮		✓	✓	✓
Next Track/Station	Short Press	⏭		✓	✓	✓

NOTE: A sound message will alert you when the volume is adjusted to the minimum or maximum level.



Bluetooth® Speaker

Repair and Refurbished Goods or Parts Notice

Unfortunately, from time to time, faulty products are manufactured which need to be returned to the Supplier for repair.

Please be aware that if your product is capable of retaining user-generated data (such as files stored on a computer hard drive, telephone numbers stored on a mobile telephone, songs stored on a portable media player, games saved on a games console or files stored on a USB memory stick) during the process of repair, some or all of your stored data may be lost.

We recommend you save this data elsewhere prior to sending the product for repair.

You should also be aware that rather than repairing goods, we may replace them with refurbished goods of the same type or use refurbished parts in the repair process.

Please be assured though, refurbished parts or replacements are only used where they meet ALDI's stringent quality specifications.

If at any time you feel your repair is being handled unsatisfactorily, you may escalate your complaint. Please telephone us on 1300 777 137 or write to us at:

UNCLE BILL'S AUSTRALIA PTY LTD
48B Egerton Street
Silverwater NSW 1811 Australia

1300 777 137
Opening Hours - 9:00am - 4:30pm (Mon-Fri), 9:00am - 3:00pm (Sat)
service@unclebills.com.au
www.signifyelectronics.com.au



Other Useful Information

Cleaning and Maintenance

- Before cleaning the Speaker, ensure the Speaker is switched off and disconnected from any power source.
- The Speaker is likely only to require regular “dusting” to keep it clean. Use a standard duster, or dry soft microfibre cloth to remove the dust from the Speaker. Remove dust from the Speaker regularly.
- If the Speaker becomes soiled with anything other than dust on its exterior, clean the exterior of the Speaker by wiping over the surface with a slightly damp cloth and then polish with a soft dry cloth. Ensure that no moisture or liquid enters the Speaker.
- Be careful when wiping over the Speaker, that you do not apply too much pressure, as there is a risk that you may break parts.
- Do not use detergents or abrasive cleaners, and do not allow moisture, water or other liquid to enter the Speaker.

Storage

When the Speaker is not in use, disconnect it from any power source and store in a cool, dry and well ventilated location out of direct sunlight. Ensure that it is not subject to humidity.

Other Useful Information (cont.)

Responsible Disposal

At the end of its working life, do not throw this appliance out with your household rubbish. Electrical and electronic products contain substances that can have a detrimental effect on the environment and human health if disposed of inappropriately. Observe any local regulations regarding the disposal of electrical consumer goods and dispose of it appropriately for recycling. Contact your local authorities for advice on recycling facilities in your area.

Please keep the original packaging carton and materials in a safe place. It will help to prevent any damage if the product needs to be transported in the future. In the event it is to be disposed of, please recycle all packaging material where possible.

If you require another copy of this instruction manual, please contact service@unclebills.com.au to obtain an electronic copy.

The Speaker has been fully tested and meets all requirements as set out by the below testing standards:

AS/NZS 60065

Trademarks

The Bluetooth® word mark and logos are registered trademarks owned by Bluetooth SIG, Inc. and any use of such marks by the manufacturer is under license. Other trademarks and trade names are those of their respective owners.

Specification Table

MODEL:	EA1344
FREQUENCY RANGE:	FM 87.5 – 108MHz
CHARGE THROUGH USB INPUT:	5V  1A
VERSION NO:	1.7
ISSUE DATE:	24 th July, 2018

THIS DOCUMENT CONTAINS INFORMATION THAT IS SUBJECT TO CHANGE WITHOUT NOTICE.

Notes